

NOTE: Lease boundaries are the internal face of wall unless noted otherwise.

Sheet 1 of 1

PO Box 5021, GCMC QLD 9726
Ph: (07) 5631 8000
mail@bennettandbennett.com.au

Surveying, Town Planning & Spatial Services
GOLD COAST | BRISBANE | SUNSHINE COAST | IPSWICH
www.bennettandbennett.com.au

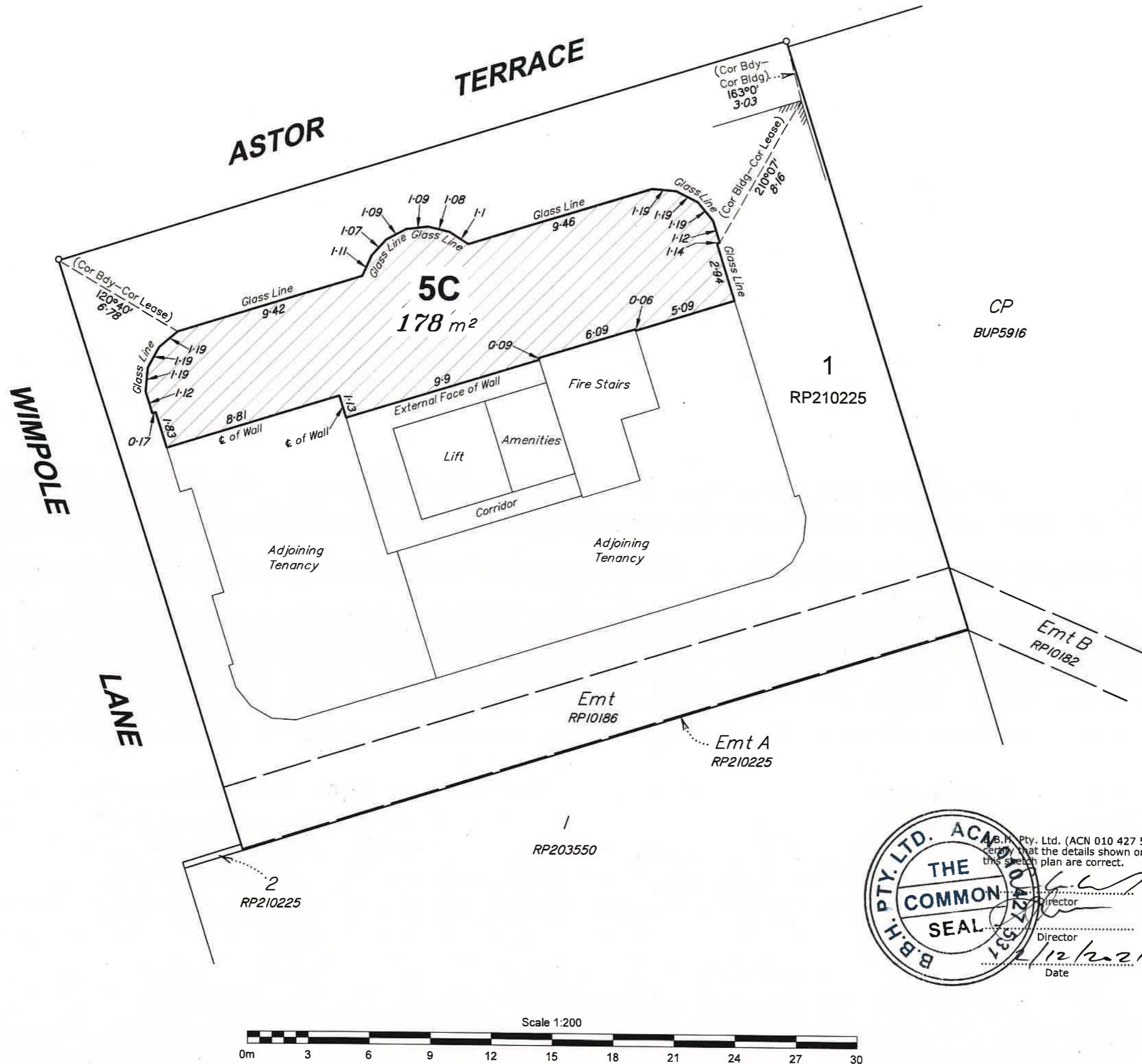

- NOTES:
1. Drawn to Scale on A3 sheet.
 2. Lease area measured in accordance with the P.C.A. recommendations for Net Lettable Area. (NLA)
 3. Title Reference : 17545152.
 4. Adjoining tenancies shown have been compiled from other sources and are diagrammatic only.
 5. Lease Boundaries are defined by structural elements, distances shown are indicative only unless noted otherwise.
 6. Meridian: RP210225.

C	Lease 5C and adjoining updated	BJL	30/11/2021
B	Lease Area Amended	JEW	2/03/2017
A	Original Issue	SS	13/8/2013
Issue	Revision	Int	Date

Title:
Plan of Lease Area "5C"
being part of the Fifth Floor of the building erected on Lot 1 on RP210225

Client: **DEMARTINI FLETCHER**

Locality: **SPRING HILL**

Local Gov: **BCC** Prepared By: **SS**

Surveyed By: **JH** Approved: **CW**

Date Created: **13/8/2013** Scale: **1:200**

Comp File: **13233.12D**

Plan No: **13233_002_LEA**



B.B.H. Pty. Ltd. (ACN 010 427 531),
certify that the details shown on
this sketch plan are correct.

Director

Director

Date

