

All drawings are the property of Empire Office Furniture (EOF) and only to be used for design, quoting & installation purposes between EOF and client. All furniture items shown on drawings are for pricing purposes only. Furniture selection and dimensions to be verified by the client after the final site check and before manufacture.

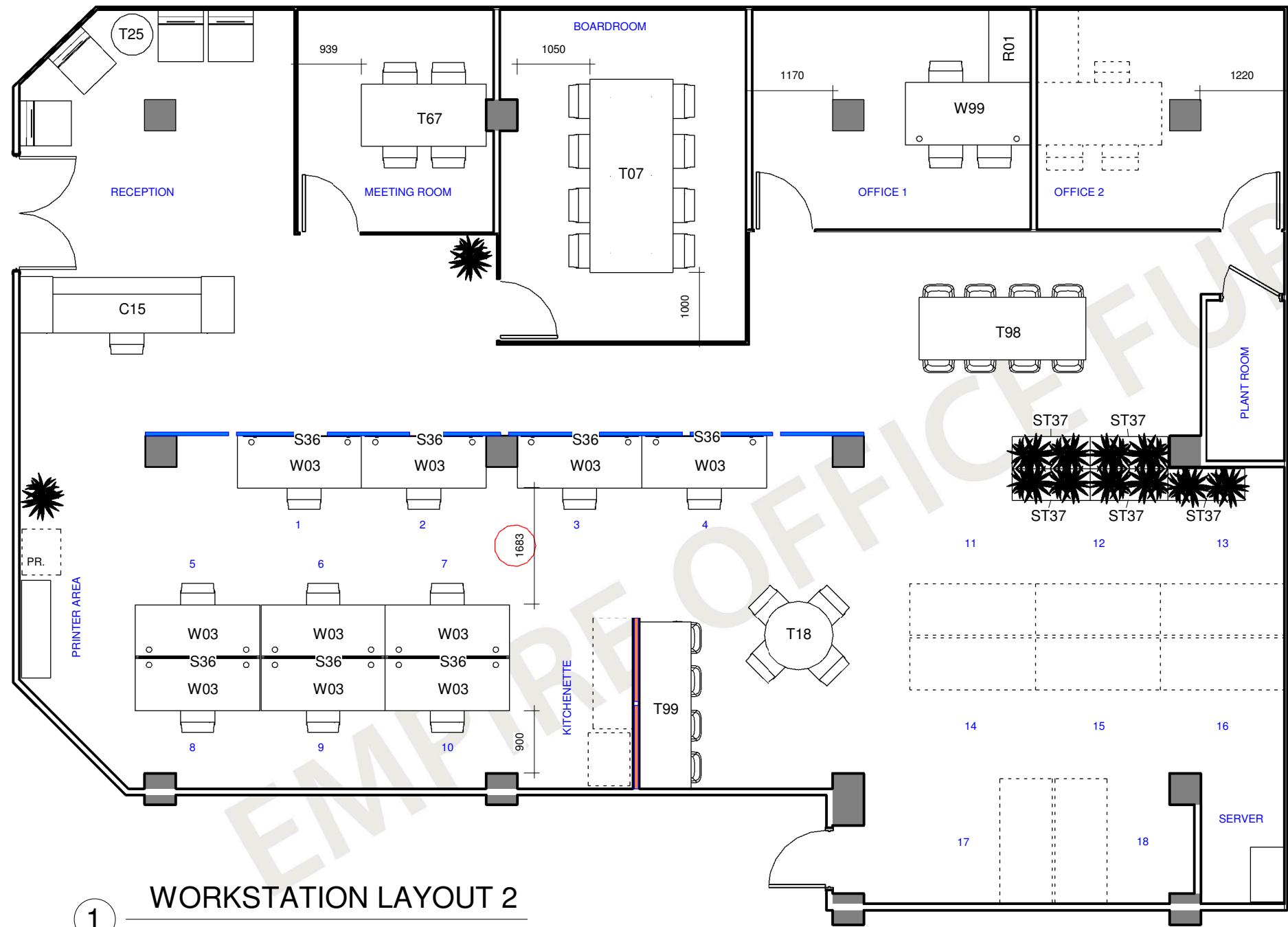

**1** WORKSTATION LAYOUT 2  
1 : 75

- - HANGING ACOUSTIC SCREENS
- - HANGING ACOUSTIC SCREENS @ 1300H APPROX.
- - - - - POTENTIAL 'FUTURE' WORKSTATIONS

SCHEDULE		
CODE	DESCRIPTION	COUNT
R01	RETURN 1050 x 600	3
T67	TABLE 1800 x 900 x 725 (H)	2
T98	BENCH 2400 x 900	2
T99	BENCH 2400 x 750	2
W03	STRAIGHT WORKTOP 1800 x 750	26
W98	SIT STAND WORKTOP 1800 x 750	2
W99	STRAIGHT WORKTOP 1800 x 900	3

SCREEN SCHEDULE		
CODE	DESCRIPTION	COUNT
S36	SCREEN 1700W	19

STORAGE SCHEDULE		
CODE	DESCRIPTION	COUNT
ST37	TAMBOUR DOOR CUPBOARD (W/ PLANTER BOX) 1120 x 460 x 1010 (H)	10

TABLE SCHEDULE		
CODE	DESCRIPTION	COUNT
T07	RECTANGULAR BOARDROOM TABLE 2800 x 1200	2
T18	ROUND TABLE 1000 (DIA)	2
T25	COFFEE TABLE 600 (DIA)	2

DESK SCHEDULE		
CODE	DESCRIPTION	COUNT
C15	RECEPTION COUNTER 3100 x 810 x 1150 (H)	2

it's easier with **empire** CORPORATE PROJECTS  
www.empirefurniture.com.au

Client: **DE MARTINI FLETCHER**  
**WORKTATION LAYOUT 2**

REV	DESCRIPTION	DATE
A	PRELIMINARY LAYOUT	15.04.19
B	AMENDMENTS	16.04.19
D	ADD PLANT ROOM/SERVER	18.04.19

**CERTIFICATION**  
Certification and compliance of appropriate building codes and standards to be confirmed with certifiers by client prior to installation as is not the responsibility of EOF.

Floor Level	<b>45 Victoria Street, Mackay</b>
TWO	
Project Reference	MK-DEMART
Date	18.04.19
Drawn by	SK
Checked by	CE
<b>D 102</b>	
Scale	1 : 75