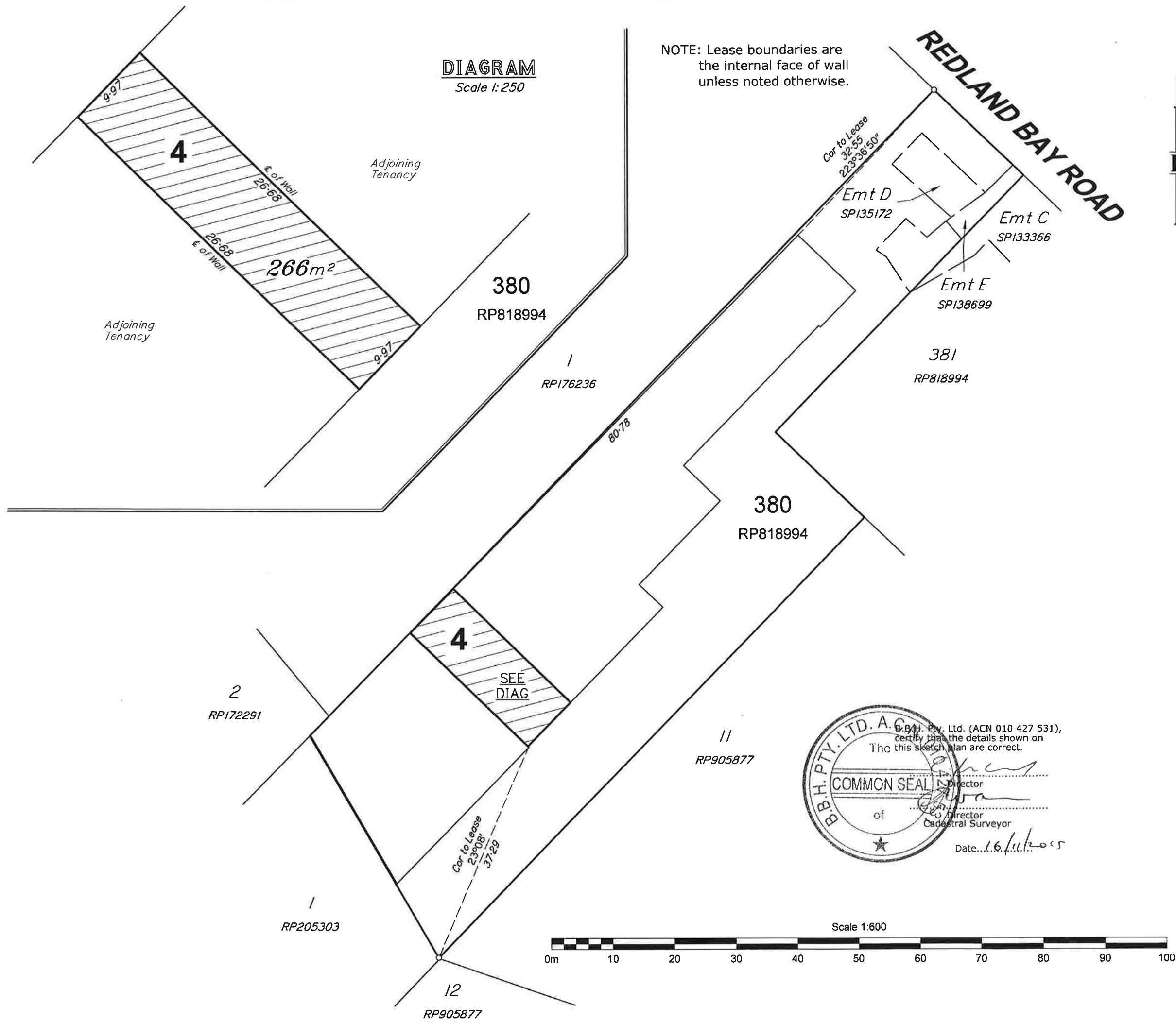

**DIAGRAM**  
Scale 1:250

NOTE: Lease boundaries are the internal face of wall unless noted otherwise.



- NOTES:
1. Drawn to Scale on A3 sheet
  2. Lease area measured in accordance with the P.C.A. recommendations for Gross Lettable Area Retail. (GLAR)
  3. Title Reference : 50181910
  4. Adjoining tenancies shown have been compiled from other sources and are diagrammatic only.
  5. Lease Boundaries are defined by structural elements, distances shown are indicative only unless noted otherwise.
  6. Meridian of RP818994

B.B.H. Pty. Ltd. (ACN 010 427 531),  
certify that the details shown on  
this sketch plan are correct.

The  
Director  
of  
Director  
Cadastral Surveyor

Date...16/11/2015

| Issue | Revision       | Int | Date       |
|-------|----------------|-----|------------|
| A     | Original Issue | DCM | 13/11/2015 |

Title:  
**Plan of Lease Area "4"**  
being part of the Ground Floor of  
the building erected on  
Lot 380 on RP818994

Client: **DEMARTINI FLETCHER**

Locality: CAPALABA  
Local Gov: RCC Prepared By: DCM  
Surveyed By: AP Approved: PS  
Date Created: 13/11/2015 Scale: 1:600  
Comp File: 15156.project  
Plan No: **15156-006-LEA-A**