

B.B.H. PTY. LTD. (ACN 010 427 531)
(trading as Bennett and Bennett Group),
certify that the details shown on this
sketch plan are correct.

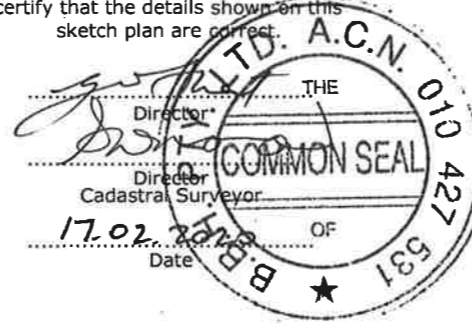

NOTE: Lease boundaries are
the internal face of wall
unless noted otherwise.



DIAGRAM
Scale 1:200
11
SP235629

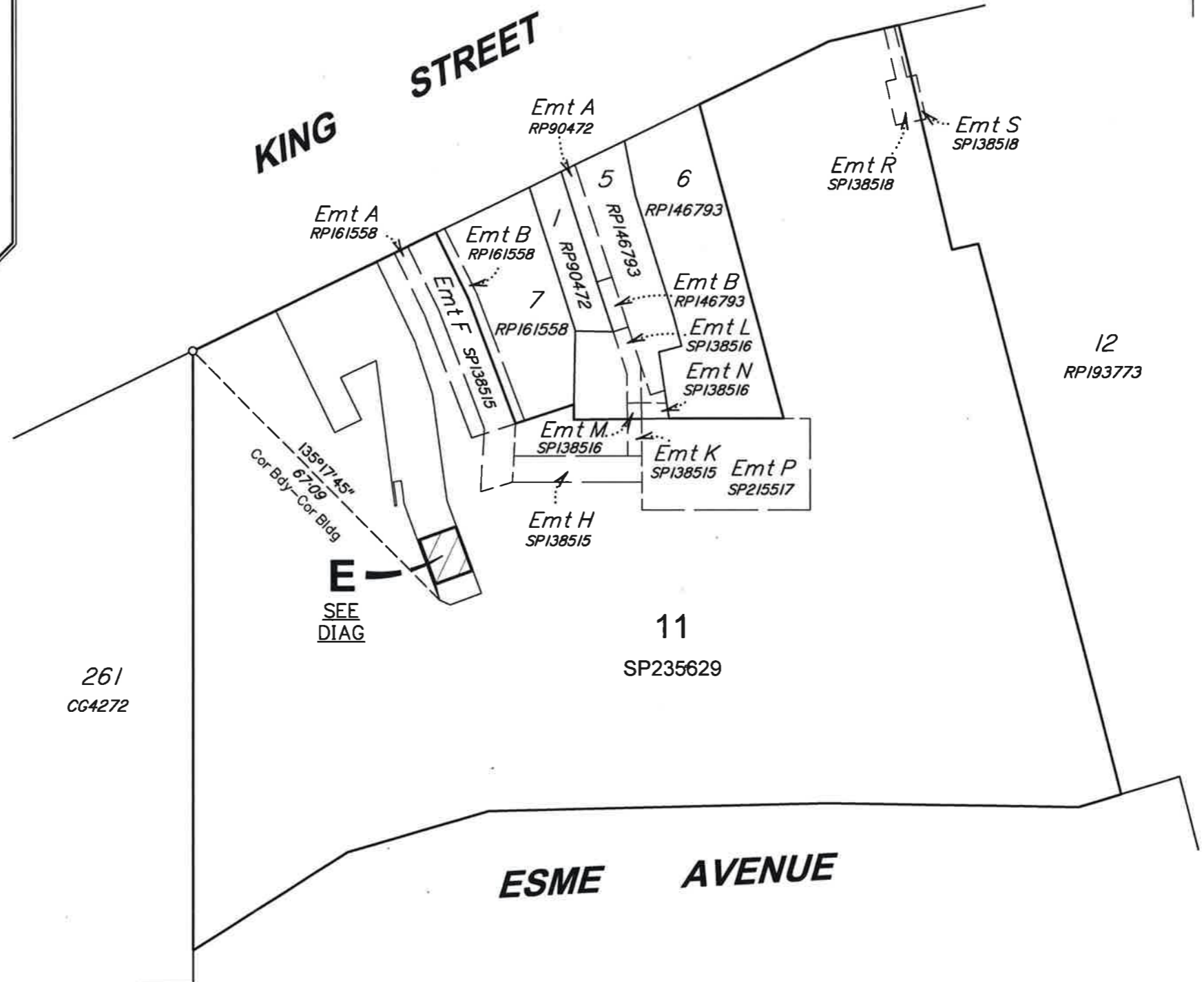
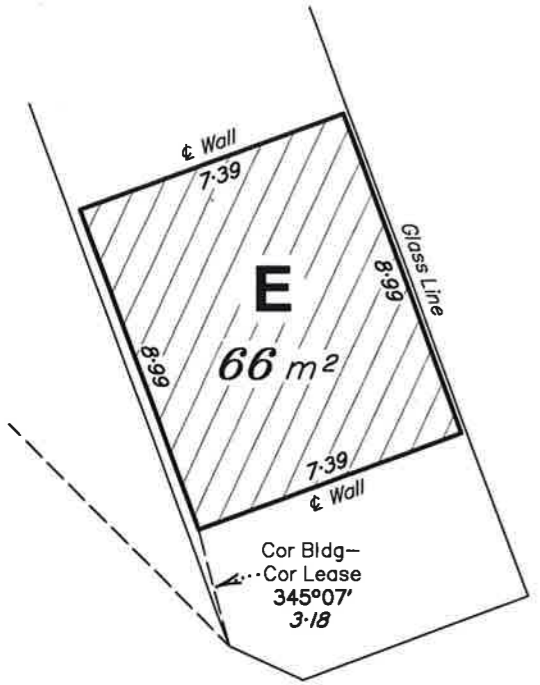

- NOTES:
1. Drawn to scale on A3 sheet.
 2. Lease area measured in accordance with the P.C.A. recommendations for Net Lettable Area. (NLA)
 3. Title Reference : 50820729
 4. Adjoining tenancies shown have been compiled from other sources and are diagrammatic only.
 5. Lease boundaries are defined by structural elements, distances shown are indicative only unless noted otherwise.
 6. Meridian of SP235629.

| A | Original Issue | ARS | 14/2/2020 |
|-------|----------------|-----|-----------|
| Issue | Revision | Int | Date |

Title:
Plan of Lease Area "E"
being part of the Ground Floor of
Building A erected on Lot 11 on
SP235629

| | |
|---------------|---------------------|
| Client: | DE MARTINI FLETCHER |
| Locality: | CABOOLTURE |
| Local Gov: | SCRC |
| Prepared By: | ARS |
| Surveyed By: | JH |
| Approved: | DC |
| Date Created: | 14/2/2020 |
| Scale: | 1:1000 |
| Comp File: | 200183.project |
| Plan No: | 200183_002_LEA |

