

PLAN OF AN AREA TO BE LEASED

KING ST

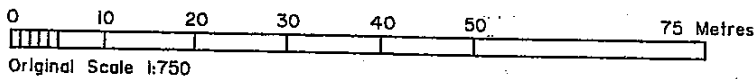
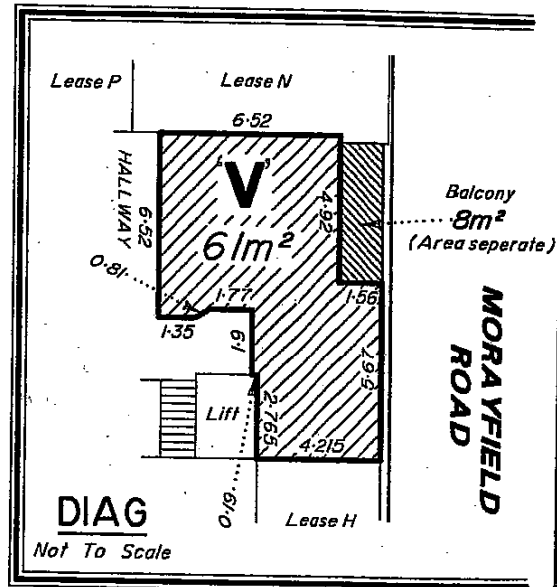
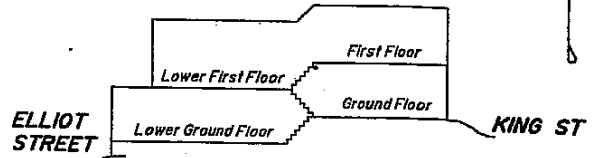
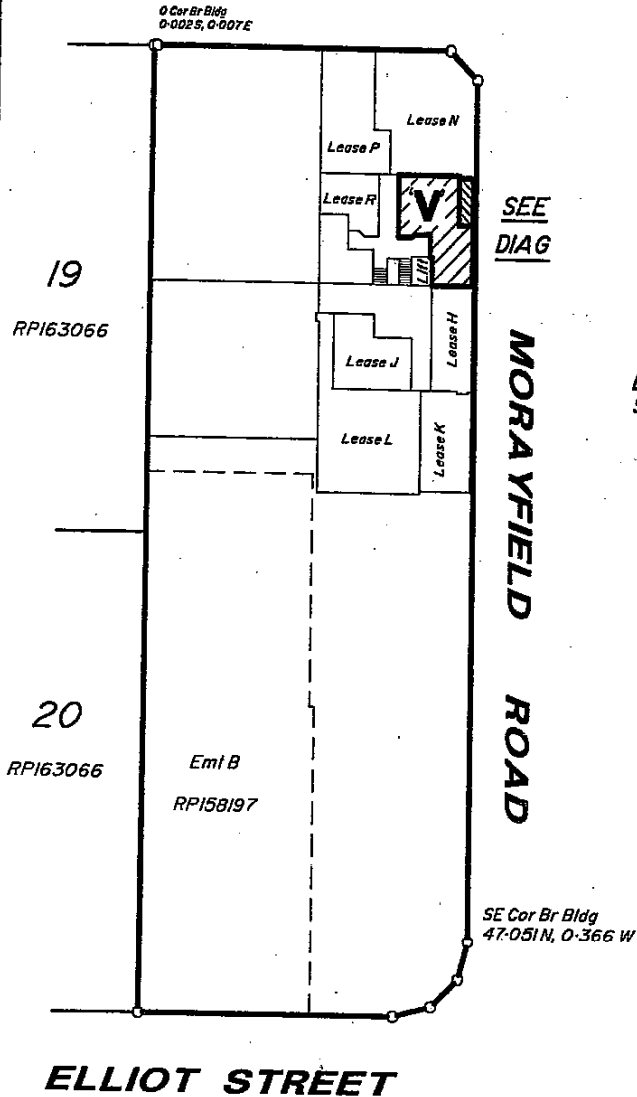

LEASE V
BEING PART OF THE FIRST FLOOR OF A
BUILDING ERECTED ON LOT 1 ON SP142146
PARISH OF CANNING
COUNTY OF CANNING

AREAS DEFINED BY NETT LETTABLE AREA (NLA)

SURVEYORS REF: 040422/LV
DATE: 21/03/05

Ken Hicks & Associates Pty Ltd A611 (010 278 823),
 Licensed Surveyor, certify that the details shown
 on this sketch plan are correct.

Director _____
 Director & _____
 Licensed Surveyor _____ Date 23/03/05



ACCREDITED SURVEYOR

KHA **KEN HICKS & ASSOCIATES** PTY LTD
CONSULTING SURVEYORS & TOWN PLANNERS
 A.C.N. 010 278 823