

PLAN OF AN AREA TO BE LEASED

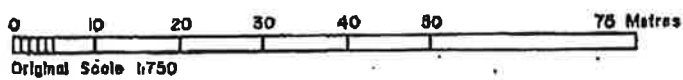
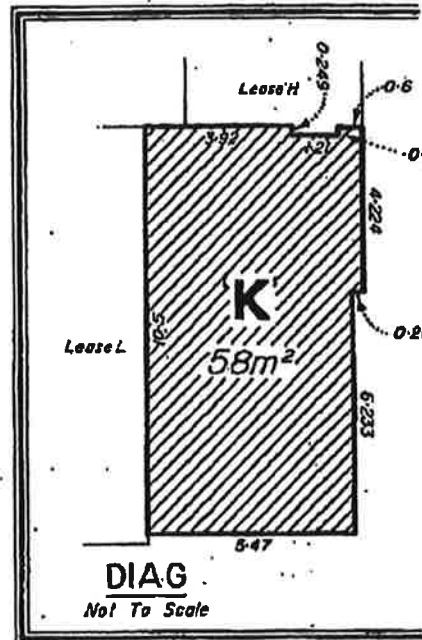
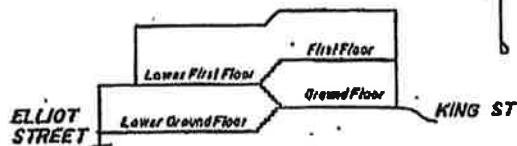
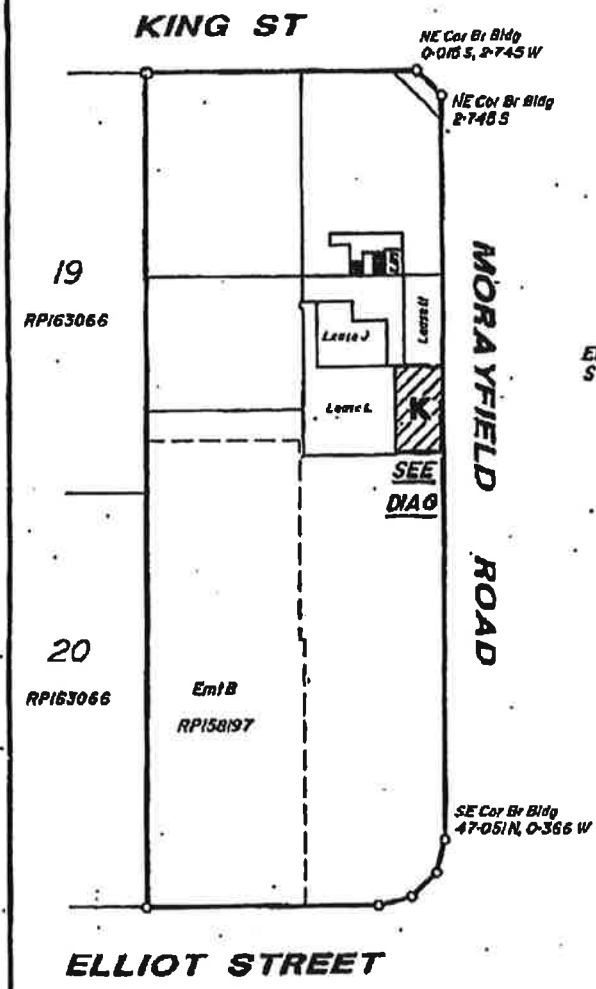

LEASE K
 BEING PART OF THE LOWER FIRST FLOOR OF A
 BUILDING ERECTED ON LOT 1 ON SP142146
 PARISH OF CANNING
 COUNTY OF CANNING

AREAS DEFINED BY NETT LETTABLE AREA (NLA)

SURVEYORS REF: 040422/LK
 DATE: 17/05/04

Ken Hicks & Associates Pty Ltd (010 278 823),
 Licensed Surveyors, certifying that the details shown
 on this plan have been carried out in accordance with the
 provisions of the Survey Act 1981.

Director: [Signature]

Director: [Signature]

Licensed Surveyor: [Signature]

19/05/04

ACCREDITED SURVEYOR

KA **KEN HICKS & ASSOCIATES** PTY LTD
 CONSULTING SURVEYORS & TOWN PLANNERS
 A.C.N. 010 278 823

14-LEASE 8-97