

PLAN OF AN AREA TO BE LEASED

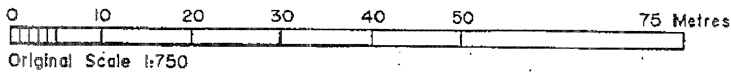
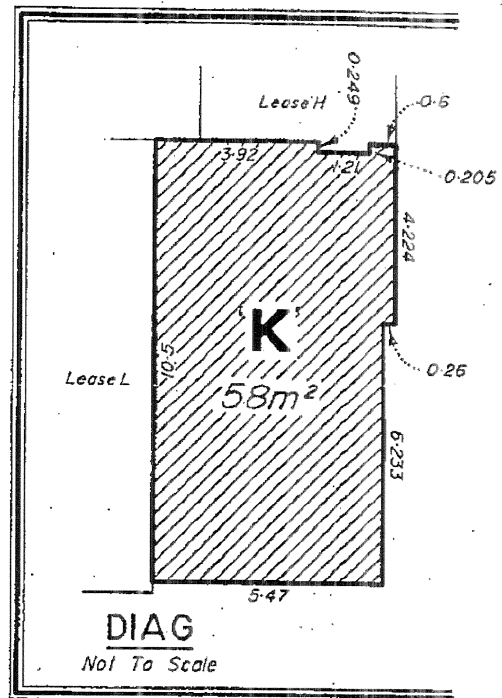
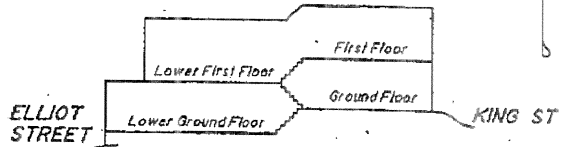
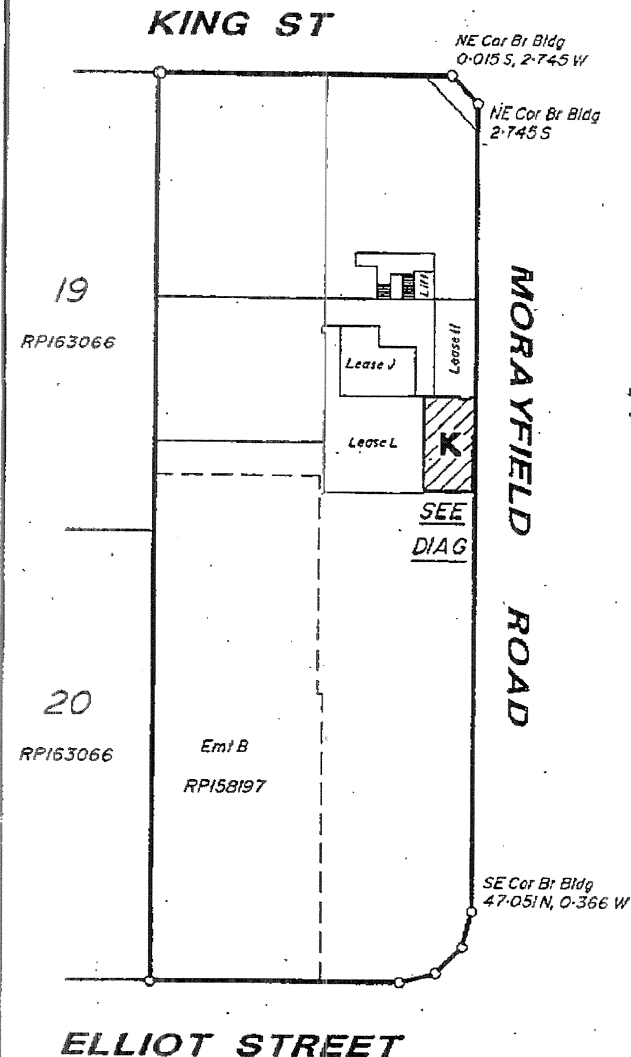

LEASE K
BEING PART OF THE LOWER FIRST FLOOR OF A
BUILDING ERECTED ON LOT 1 ON SP142146
PARISH OF CANNING
COUNTY OF CANNING

AREAS DEFINED BY NETT LETTABLE AREA (NLA)

SURVEYORS REF: 040422/LK
DATE: 17/05/04

Ken Hicks & Associates Pty Ltd (A.C.N. 10 278 823),
Licensed Surveyors certify that the details shown
on this sketch plan are correct.

Director

Director

Licensed Surveyor

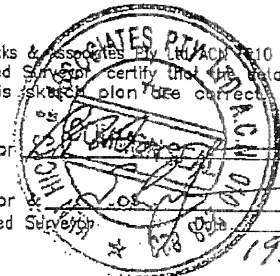

ACCREDITED
SURVEYOR



**KEN HICKS &
ASSOCIATES** PTY LTD
CONSULTING SURVEYORS & TOWN PLANNERS
A.C.N. 010 278 823

PLAN OF AN AREA TO BE LEASED

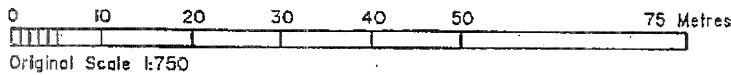
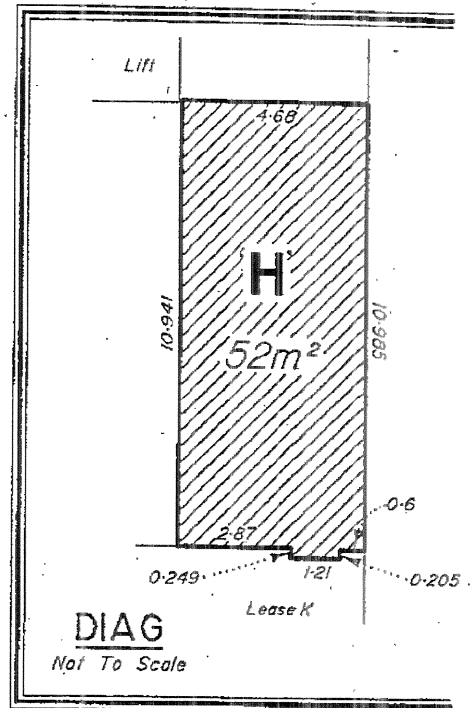
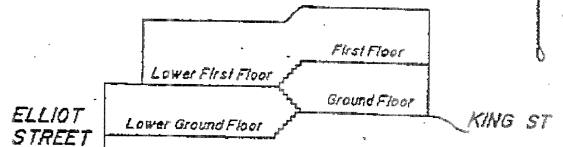
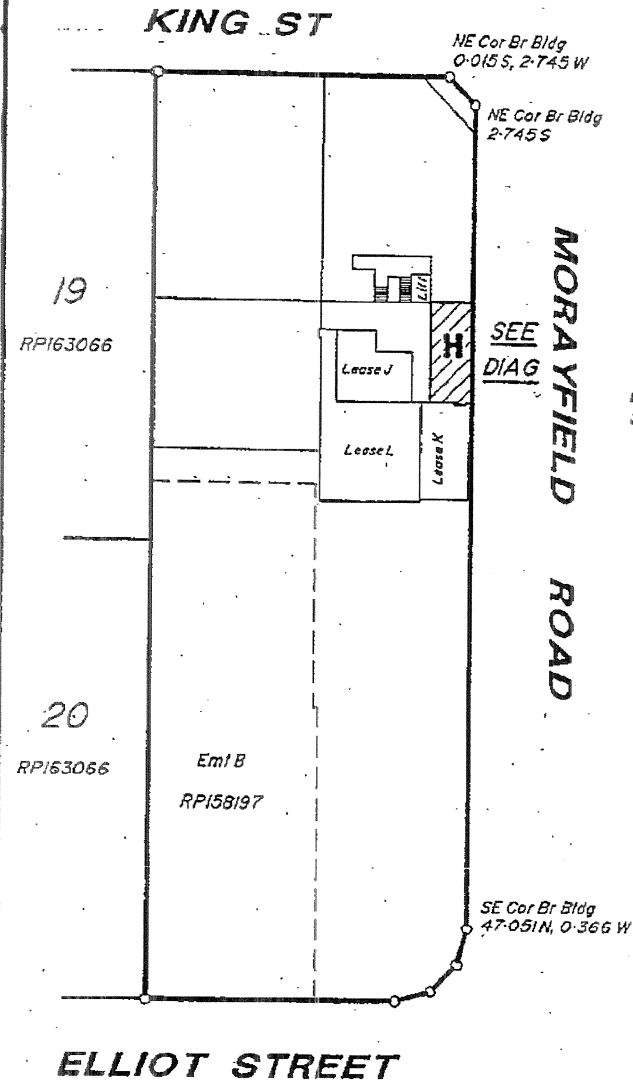

LEASE H
 BEING PART OF THE LOWER FIRST FLOOR OF A
 BUILDING ERECTED ON LOT 1 ON SP142148
 PARISH OF CANNING
 COUNTY OF CANNING

Ken Hicks & Associates Pty Ltd (A.C.N. 0 278 823),
 Licensed Surveyor, certify that the details shown
 on this sketch plan are correct.

Director

Director

Licensed Surveyor

Date

19/05/04

AREAS DEFINED BY NETT LETTABLE AREA (NLA)

SURVEYORS REF: 040422/LH

DATE: 17/05/04

ACCREDITED
 SURVEYOR

KHA **KEN HICKS & ASSOCIATES** PTY LTD
 CONSULTING SURVEYORS & TOWN PLANNERS
 A.C.N. 010 278 823

A4-LEASE 9-87