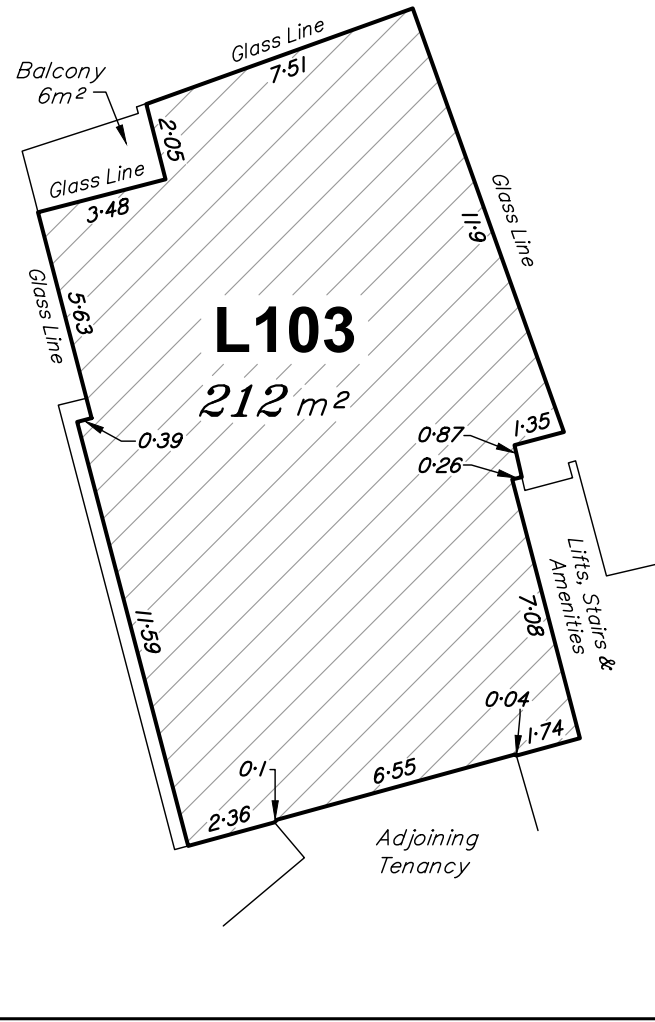

**DIAGRAM**  
Scale 1:200

NOTE: Lease boundaries are the internal face of wall unless noted otherwise.



B.B.H. PTY. LTD. (ACN 010 427 531)  
(trading as Bennett and Bennett Group)  
certify that the details shown on this sketch plan are correct.

Director  
Director  
22/05/2023  
Date



Scale 1:1000

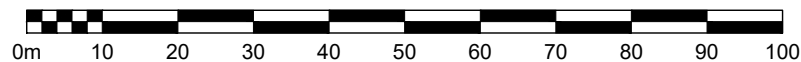

Sheet 1 of 1

PO Box 5021, GCMC QLD 9726  
Ph: (07) 5631 8000  
mail@bennettandbennett.com.au

Surveying, Town Planning & Spatial Services  
GOLD COAST | BRISBANE | SUNSHINE COAST | NORTHERN RIVERS  
www.bennettandbennett.com.au

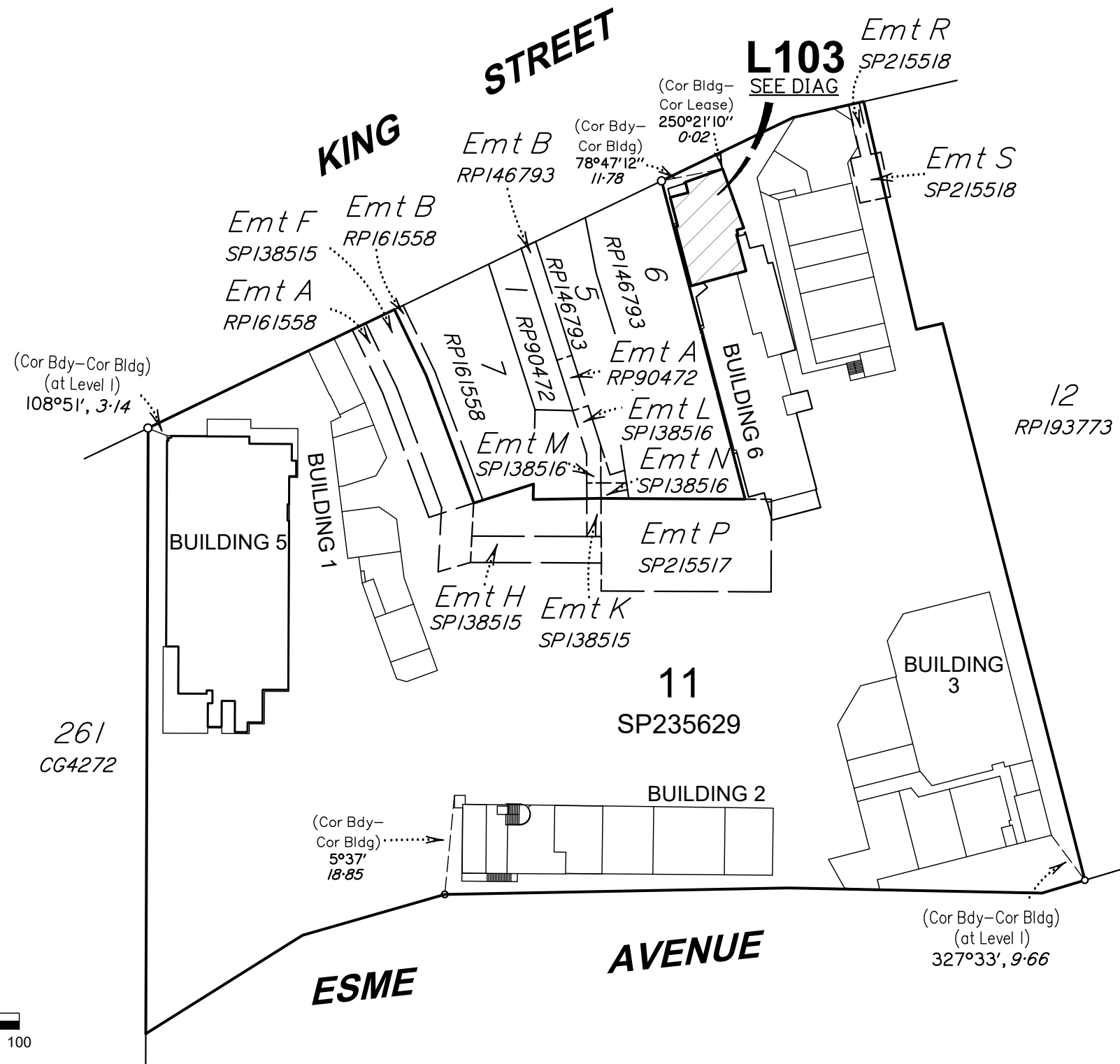

- NOTES:
1. Drawn to scale on A3 sheet.
  2. Lease area measured in accordance with the P.C.A. recommendations for Net Lettable Area. (NLA)
  3. Title Reference : 50820729
  4. Adjoining tenancies shown have been compiled from other sources and are diagrammatic only.
  5. Lease boundaries are defined by structural elements, distances shown are indicative only unless noted otherwise.
  6. Meridian of IS200592

A	Original Issue	AMB	17/05/2023
Issue	Revision	Int	Date

**Plan of Lease Area "L103"**  
being part of Level 1 of the building erected on Lot 11 on SP235629

Client: **DE MARTINI FLETCHER**

Locality:	CABOOLTURE
Local Gov:	MBRC
Prepared By:	AMB
Surveyed By:	MD
Approved:	KJ
Date Created:	17/05/2023
Scale:	1:1000
Comp File:	200708.PROJECT
Plan No:	<b>200708_009_LEA</b>